

NOMADE 2

Designer

Didier Gomez



PRODUCTS

LARGE SETTEE



Dimensions

Height 780 mm
Width 2,170 mm
Depth 910 mm
Seat height 380 mm
Weight 100 kg
Seats 3 places

SMALL 1-ARMED SETTEE RIGHT

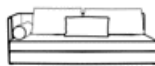

Dimensions

Height 780 mm
Width 1,720 mm
Depth 910 mm
Seat height 380 mm
Weight 76 kg
Seats 2 places

SMALL 1-ARMED SETTEE LEFT



Dimensions

Height 780 mm
Width 1,720 mm
Depth 910 mm
Seat height 380 mm
Weight 76 kg
Seats 2 places

LARGE 1-ARMED SETTEE RIGHT



Dimensions

Height 780 mm
Width 2,120 mm
Depth 910 mm
Seat height 380 mm
Weight 90.5 kg
Seats 3 places

LARGE 1-ARMED SETTEE LEFT

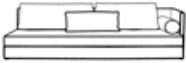

Dimensions

Height 780 mm
Width 2,120 mm
Depth 910 mm
Seat height 380 mm
Weight 90.5 kg
Seats 3 places

SMALL CHAISE LONGUE ARM RIGHT



Dimensions

Height 780 mm
Width 1,720 mm
Depth 910 mm
Seat height 380 mm
Weight 74 kg
Seats 2 places

SMALL CHAISE LONGUE ARM LEFT



Dimensions

Height 780 mm
Width 1,720 mm
Depth 910 mm
Seat height 380 mm
Weight 74 kg
Seats 2 places

LARGE CHAISE LONGUE ARM RIGHT



Dimensions

Height 780 mm
Width 2,120 mm
Depth 910 mm
Seat height 380 mm
Weight 79 kg
Seats 2 places

LARGE CHAISE LONGUE ARM LEFT



Dimensions

Height 780 mm
Width 2,120 mm
Depth 910 mm
Seat height 380 mm
Weight 79 kg
Seats 2 places

COMPOSITION A



Dimensions

Height 780 mm
Width 3,440 mm
Depth 910 mm
Seat height 380 mm

COMPOSITION B

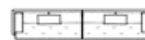

Dimensions

Height 780 mm
Width 4,240 mm
Depth 910 mm
Seat height 380 mm

COMPOSITION C

COMPOSITION D

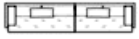
**Dimensions**

Height 780 mm
Width 3,840 mm
Depth 910 mm
Seat height 380 mm

**Dimensions**

Height 780 mm
Width 3,840 mm
Depth 910 mm
Seat height 380 mm

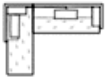
COMPOSITION E**Dimensions**

Height 780 mm
Width 3,030 mm
Depth 2,120 mm
Seat height 380 mm

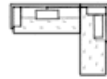
COMPOSITION F**Dimensions**

Height 780 mm
Width 3,030 mm
Depth 2,120 mm
Seat height 380 mm

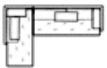
COMPOSITION G**Dimensions**

Height 780 mm
Width 3,030 mm
Depth 1,720 mm
Seat height 380 mm

COMPOSITION H**Dimensions**

Height 780 mm
Width 3,030 mm
Depth 1,720 mm
Seat height 380 mm

COMPOSITION I**Dimensions**

Height 780 mm
Width 2,630 mm
Depth 1,720 mm
Seat height 380 mm

COMPOSITION J**Dimensions**

Height 780 mm
Width 2,630 mm
Depth 1,720 mm
Seat height 380 mm

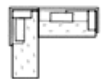
COMPOSITION K**Dimensions**

Height 780 mm
Width 2,630 mm
Depth 2,120 mm
Seat height 380 mm

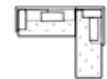
COMPOSITION L**Dimensions**

Height 780 mm
Width 2,630 mm
Depth 2,120 mm
Seat height 380 mm

Technical characteristics

CONSTRUCTION

Frame in square-section Epoxy lacquered tubular steel (25 mm) and panels of particleboard clad in polyether foam 28 kg/m³ - 4 kPa. Items are joined together by steel linking-pieces (NB except footstool).

COMFORT

Suspension via a base in 2 densities of high resilience polyurethane Bultex foam, dominant 35 kg/m³ - 2,6 kPa for the soft version and in 2 densities of polyether foam, dominant 28 kg/m³ - 4 kPa for the firm version. Seat cushions in 2 densities of high resilience polyurethane Bultex foam, dominant 32 kg/m³ - 2.1 kPa clad in polyether foam 25 kg/m³ - 1.2 kPa and 200 g/m² polyester quilting. Back cushions, lumbar and bolster filled with feathers (90 % feathers / 10 % down), compressibility H 88 mm with compartmented liner.

MAKING-UP

Baguette stitching on structure. Seat covers quilted with 100 g/m² polyester quilting with piped detailing on the edges and stitched detailing. Seat cushions have removable covers. Back cushions with comb stitch detail (in either toning or contrasting thread); lumbar and bolsters are piped as per seat; covers are zipped in place and therefore removable. The lower face of the seat cushion of the large settee, large one-arm settees, large chaises longue and the two sections of the convertible corner group is covered in a 100 % cotton piqué ticking which is both removable and dry cleanable. This ticking is treated with 'HealthGuard' - antibacterial, fungicidal.

FABRICS

Since the structure (base and back), seat mattress, 3 back cushions, lumbar cushion and bolster are priced separately, it is possible - and recommended - to create multicolour and/or multi-material compositions.